

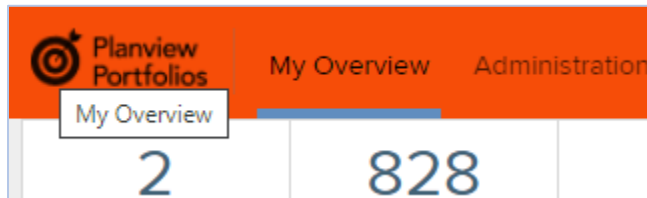

1. Application names/logos updated:

a. The main logo (top, left):



b. on **Application Selector**:

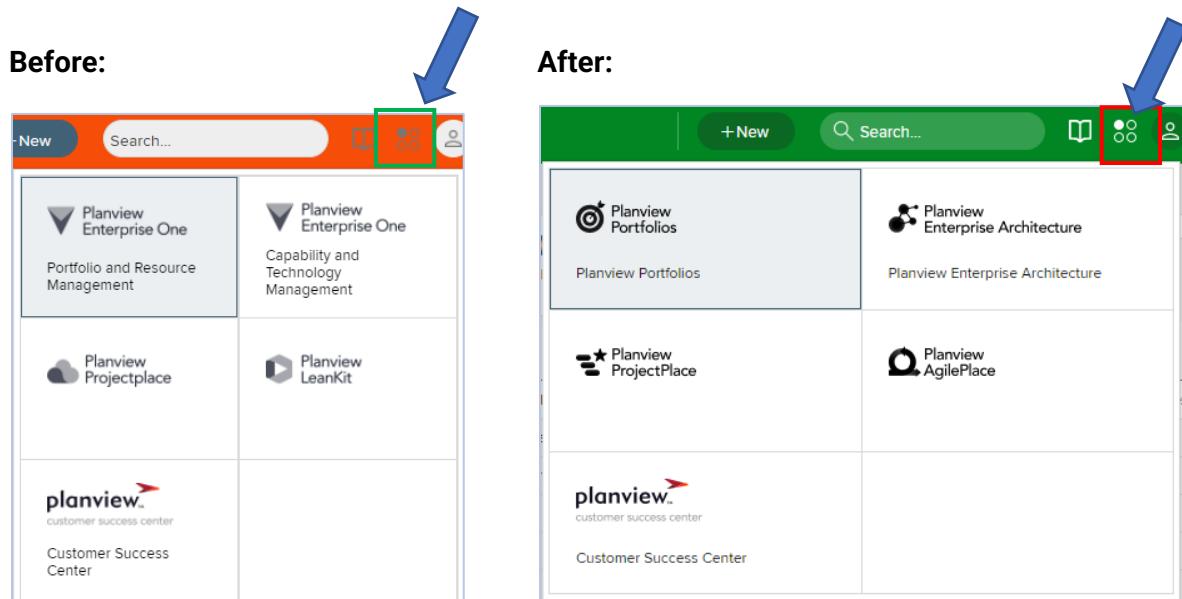

2. Multi-column sort

To sort data by multiple columns:

1. Click the relevant tile on the ribbon.
2. Press the **Shift** key, then click the first column header by which you want data to be sorted.
3. Click additional column headers while continuing to press the **Shift** key to add those columns to the set of columns being sorted. Repeat this process to add more columns to the sort order.
4. If a column is already in the set of columns being sorted, clicking its header while pressing the Shift key toggles the sort direction (ascending vs. descending).

To remove a column from the set of columns being sorted, click the column's header while pressing the Ctrl key.

TIP

To identify the order in which the columns you selected are being sorted, the application displays a number next to each selected column's header. For example, if you sort the data by the **Schedule Start** column and then by the **Schedule Finish** column, the application displays a 1 by the **Schedule Start** column header and a 2 by **Schedule Finish**. An icon (such as ↓ or ↑) also appears in the column header to indicate the direction of the sort.

Example: **Portfolio View**, using **Portfolio Manager** tile, sorting first on **Investment Type**, then on **Investment Approval Status**, then on **Item Classification Governance**

1816 Portfolio Manager	597 Active Lifecycle Steps	33 Action Items	Action Items Dashboard	more ...	
<input type="text" value="Type to filter"/>					
	Name	Investment Type ↑ 1	Item Classification Governance ↓ 3	Investment Approval Status ↓ 2	Proje

3. Rows are taller.

Example below shows prior release (September 2022) and the new release (October 2022), side by side. The zoom on both is 100%. (Screen shots are to show line size differences...data does not necessarily match.)

- Font appears larger and each line appears space a little further apart.
- Fewer lines are visible in the same amount of space

TIP: To see more lines on your screen, reduce your browser's zoom setting.

September 2022

October 2022

Parent Description	Investment Approval		Name	W
129 Department o	Un-Assigned	⋮	☆ DataSage Architecture & Infrastructure, PowerBI	C
132 Department o	Un-Assigned	⋮	☆ DataSage O&M Support	C
157 Compensator	Un-Assigned	⋮	☆ Procurement FAACT O&M Support FY21	C
199 Department o	Un-Assigned	⋮	☆ FAACT Support for FY22	1
402 Marine Resou	Completed	⋮	☆ Staff Augmentation for ODGA Maintenance & Sup	1
403 Department o	Un-Assigned	⋮	☆ Entity Matching Solution for ODGA	1
440 Department o	Completed	⋮	☆ Staff Augmentation for ODGA Maintenance & Sup	1
201 Department o	Investment Busine	⋮		
202 Library of Virg	Un-Assigned	⋮		

4. Cell & row selection/hover indicator

Multiple row selection only looks a little different.

A side-by-side comparison shows the difference between the September 2022 release and October 2022 release when selecting multiple rows.

- Dark line around entire selection, not each individual cell.
- Dashed underline under editable field when hovering over it.

September 2022

October 2022

Name ↓	Planned Initiation Start Date	Reporting Period	Proport		Name ↓	Planned Initi	Reporting Period	Proport
Data Query Procurement	6/13/2022 12:00 AM		186 S	⋮ ☆	Data Query Procurement	6/13/2022		186 S
DSS - Salesforce License	8/30/2022 12:00 AM		180 S	⋮ ☆	DSS - Salesforce License Buy DSS LIHE	8/30/2022		180 S
Transactional Messaging			188 S	⋮ ☆	Transactional Messaging Services Rene			188 S
.Net DevOPS Enhancem	6/1/2021 12:00 AM	Jun 2021	180 S	⋮ ☆	.Net DevOPS Enhancements	6/1/2021	Jun 2021	180 S
.Net DevOPS Maintenanc	6/1/2021 08:00 AM	Jul 2022	180 S	⋮ ☆	.Net DevOPS Maintenance	6/1/2021	Jul 2022	180 S
123 DMA Procure AV eq			187 S	⋮ ☆				

Dashed underline on hover

.Net DevOPS Maintenance